

Cu-ETP nach DIN EN13600, galv. Sn
wärmebeständig bis +125°C



material: Cu-ETP, e-plate Sn
heat resistant up to +125°C

Querschnitt (in mm ²) wire size	Flanschloch für Bolzen stud size	Abmessungen (in mm) dimensions (mm)							VE in St. pack qty.	Gewicht kg/100 St. weight	Bestell-Nr. part no.
		d1	l1	b	d2	d3	l2	l3			
6	M 5	3,5	9,0	10,0	5,3	6,5	7,5	9,0	100	0,600	106390
6	M 6	3,5	9,0	12,0	6,4	6,5	7,5	10,0	100	0,620	106392
6	M 8	3,5	9,0	15,0	8,4	6,5	10,0	13,0	100	0,640	106394
6	M 10	3,5	9,0	17,0	10,5	6,5	12,0	15,0	100	0,700	106396
6	M 12	3,5	9,0	19,0	13,2	6,5	13,0	17,0	100	0,700	106398
10	M 5	4,5	10,0	12,0	5,3	7,0	6,5	10,0	100	0,590	106400
10	M 6	4,5	10,0	12,0	6,4	7,0	6,5	10,0	100	0,570	106402
10	M 8	4,5	10,0	15,0	8,4	7,0	10,0	13,0	100	0,630	106404
10	M 10	4,5	10,0	17,0	10,5	7,0	12,0	15,0	100	0,680	106406
10	M 12	4,5	10,0	19,0	13,2	7,0	13,0	18,0	100	0,680	106408
16	M 5	5,5	13,0	12,0	5,3	8,5	7,5	10,0	100	1,050	106410
16	M 6	5,5	13,0	12,0	6,4	8,5	7,5	11,0	100	1,030	106412
16	M 8	5,5	13,0	15,0	8,4	8,5	10,0	13,0	100	1,150	106414
16	M 10	5,5	13,0	17,0	10,5	8,5	12,0	15,0	100	1,150	106416
16	M 12	5,5	13,0	19,0	13,2	8,5	13,0	18,0	100	1,200	106418
25	M 5	7,0	15,0	14,0	5,3	10,0	7,5	11,0	100	1,430	106420
25	M 6	7,0	15,0	14,0	6,4	10,0	7,5	11,0	100	1,400	106422
25	M 8	7,0	15,0	16,0	8,4	10,0	10,0	13,0	100	1,480	106424
25	M 10	7,0	15,0	18,0	10,5	10,0	12,0	15,0	100	1,570	106426
25	M 12	7,0	15,0	19,0	13,2	10,0	13,0	18,0	100	1,550	106428
25	M 14	7,0	15,0	21,0	15,0	10,0	14,5	20,0	100	1,550	106430
35	M 6	8,5	17,0	17,0	6,4	12,0	7,5	11,0	100	2,050	106432
35	M 8	8,5	17,0	17,0	8,4	12,0	10,0	13,0	100	2,250	106434
35	M 10	8,5	17,0	19,0	10,5	12,0	12,0	15,0	100	2,290	106436
35	M 12	8,5	17,0	21,0	13,2	12,0	13,0	18,0	100	2,370	106438
35	M 14	8,5	17,0	21,0	15,0	12,0	14,5	20,0	100	2,410	106440
35	M 16	8,5	17,0	26,0	17,0	12,0	16,0	22,0	100	2,400	106442
50	M 6	10,0	19,0	20,0	6,4	14,0	10,0	13,0	100	3,430	106444
50	M 8	10,0	19,0	20,0	8,4	14,0	10,0	13,0	100	3,480	106446
50	M 10	10,0	19,0	20,0	10,5	14,0	12,0	16,0	100	3,500	106448
50	M 12	10,0	19,0	23,0	13,2	14,0	13,0	18,0	100	3,600	106450
50	M 14	10,0	19,0	23,0	15,0	14,0	14,5	20,0	100	3,650	106452
50	M 16	10,0	19,0	28,0	17,0	14,0	16,0	22,0	100	3,700	106454
50	M 20	10,0	19,0	30,0	21,0	14,0	19,0	24,0	100	3,300	106456



Cu-ETP nach DIN EN13600, galv. Sn
wärmebeständig bis +125°C

material: Cu-ETP, e-plate Sn
heat resistant up to +125°C

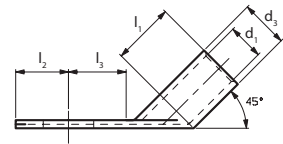
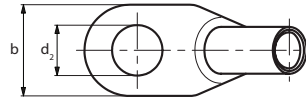

Querschnitt (in mm ²) wire size	Flanschloch für Bolzen stud size	Abmessungen (in mm) dimensions (mm)							VE in St. pack qty.	Gewicht kg/100 St. weight	Bestell-Nr. part no.
		d1	l1	b	d2	d3	l2	l3			
70	M 6	12,0	21,0	24,0	6,4	16,5	10,0	13,0	100	5,180	106458
70	M 8	12,0	21,0	24,0	8,4	16,5	10,0	14,0	100	5,200	106460
70	M 10	12,0	21,0	24,0	10,5	16,5	12,0	16,0	100	5,400	106462
70	M 12	12,0	21,0	24,0	13,2	16,5	13,0	18,0	100	5,500	106464
70	M 14	12,0	21,0	24,0	15,0	16,5	14,5	20,0	50	5,710	106466
70	M 16	12,0	21,0	28,0	17,0	16,5	16,0	22,0	50	5,940	106468
70	M 20	12,0	21,0	30,0	21,0	16,5	19,0	24,0	50	5,900	106470
95	M 8	13,5	25,0	26,0	8,4	18,0	12,0	14,0	50	6,280	106472
95	M 10	13,5	25,0	26,0	10,5	18,0	12,0	17,0	50	6,550	106474
95	M 12	13,5	25,0	26,0	13,2	18,0	13,0	18,0	50	6,570	106476
95	M 14	13,5	25,0	26,0	15,0	18,0	14,5	20,0	50	6,600	106478
95	M 16	13,5	25,0	28,0	17,0	18,0	16,0	22,0	50	6,780	106480
95	M 20	13,5	25,0	36,0	21,0	18,0	22,0	24,0	50	6,800	106482
120	M 8	15,0	26,0	28,0	8,4	19,5	14,0	16,0	50	7,350	106484
120	M 10	15,0	26,0	28,0	10,5	19,5	14,0	17,0	50	7,350	106486
120	M 12	15,0	26,0	28,0	13,2	19,5	14,0	18,0	50	7,550	106488
120	M 14	15,0	26,0	28,0	15,0	19,5	15,0	20,0	50	7,870	106490
120	M 16	15,0	26,0	30,0	17,0	19,5	16,0	22,0	50	8,030	106492
120	M 20	15,0	26,0	36,0	21,0	19,5	22,0	24,0	50	8,200	106494
150	M 10	16,5	30,0	31,0	10,5	21,0	14,0	17,0	50	8,700	106495
150	M 12	16,5	30,0	31,0	13,0	21,0	15,0	18,0	50	8,800	106496
150	M 16	16,5	30,0	31,0	17,0	21,0	16,0	22,0	50	9,100	106497
150	M 20	16,5	30,0	36,0	21,0	21,0	22,0	24,0	50	9,200	106498
185	M 10	19,0	32,0	35,0	10,5	24,0	18,0	22,0	50	12,600	106499
185	M 12	19,0	32,0	35,0	13,2	24,0	18,0	22,0	50	12,400	106500
185	M 16	19,0	32,0	35,0	17,0	24,0	18,0	22,0	50	12,800	106502
185	M 20	19,0	32,0	39,0	21,0	24,0	22,0	24,0	50	12,800	106506
240	M 10	21,0	35,0	39,0	10,5	26,0	21,5	22,0	50	16,400	106508
240	M 12	21,0	35,0	39,0	13,0	26,0	21,5	22,0	50	16,400	106510
240	M 16	21,0	35,0	39,0	17,0	26,0	21,5	22,0	50	16,000	106512
240	M 20	21,0	35,0	39,0	21,0	26,0	22,0	24,0	50	16,200	106514
300	M 12	23,5	44,0	43,0	13,0	29,5	24,0	24,0	50	24,000	106516
300	M 16	23,5	44,0	43,0	17,0	29,5	24,0	24,0	50	24,000	106518
300	M 20	23,5	44,0	43,0	21,0	29,5	24,0	24,0	50	24,400	106520